

**NOTES:**

(MATCH WITH NUMBER IN CALL-OUT ON PRINT)

NBR: TEXT:

- 1 .030 ALUM. EXTERIOR
- 2 DOUBLE REAR DOORS
  
- A 1-32" SIDE DOOR
- B 24" ATP STONEGUARD
- C 2-FLOW THRU SIDEWALL VENTS

DATE: 2/1/11    MODEL: ST610SA    ORDER NUMBER: 000000    DEALER: BRAVO STOCK    PG: 1 OF 1

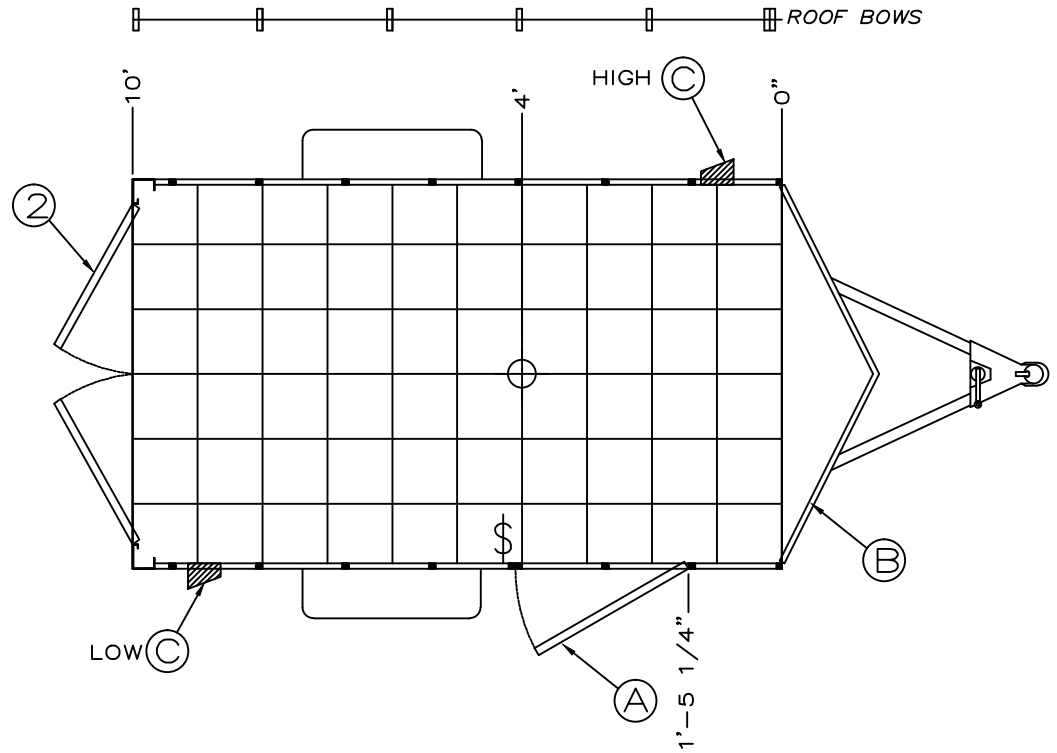

**KEY:**

- |                                |                           |   |                                      |
|--------------------------------|---------------------------|---|--------------------------------------|
| - 12v STANDARD DOME LIGHT      | - DOUBLE TUBE FLUORESCENT | - ROOF VENT<br>(LABEL AS FOLLOWS:<br>N/P = NON POWERED<br>12v = 12 VOLT POWERED<br>110v = 110 VOLT POWERED<br>W/F = WIRE & FRAME FOR AIR<br>A/C = AIR CONDITIONER | - D-RING (FLOOR & WALL)              |
| - 12v ICON STYLE DOME LIGHT    | - SINGLE TUBE FLUORESCENT | - PANEL W/ LIFELINE<br>& CABLE HATCH<br>(LABEL W/AMPERAGE)  | - E-TRACK<br>(FROM ARROW.. TO ARROW) |
| - 12v WALL SWITCH              | - 110v WALL SWITCH        | - MOTOR BASE PLUG<br>(LABEL W/AMPERAGE)   | - ATP                                |
| - 12v WALL MOUNT LOADING LIGHT | - 110v WALL RECEPT        |   |                                      |
|                                | - 110v GFI RECEPT         |   |                                      |
|                                | - QUARTZ LIGHT            |   |                                      |

APPROVED: \_\_\_\_\_

19319 COUNTY ROAD 8, BRISTOL IN 46507  
PHONE: 574.848.7500 - FAX: 574.848.7550