

MATCH LETTER OR NUMBER WITH PRINT

DATE: 09/21/2018

MODEL: SC8522TA2

ORDER NUMBER: 000000

DEALER: BRAVO STOCK

PG: 1 OF 1

- 1 .030 ALUM. EXTERIOR
- 2 DOUBLE REAR DOORS

- A 1-36" SIDE DOOR
- B 24" ATP STONEGUARD
- C 2-FLOW THRU SIDEWALL VENTS

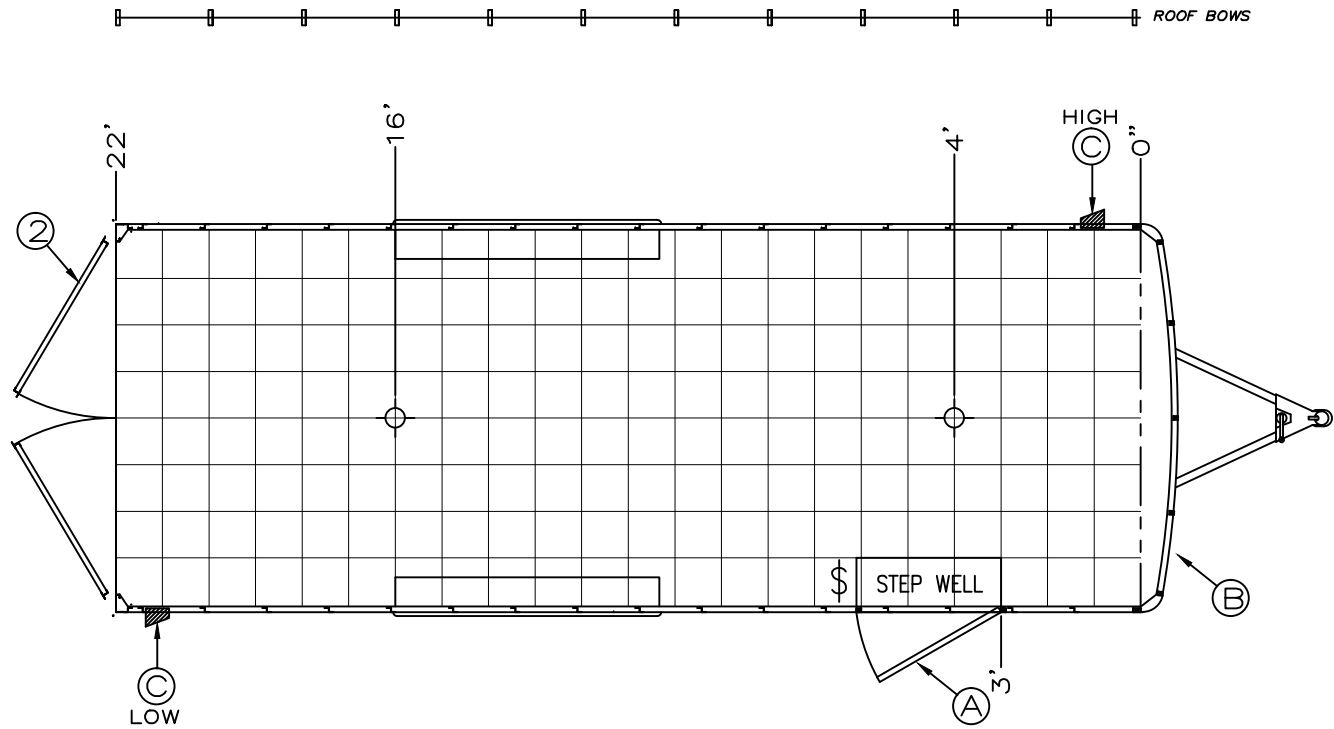

KEY: :

12 VOLT ELECTRICAL	110 VOLT ELECTRICAL	ROOF VENTS	REVISION:
<ul style="list-style-type: none"> ○ - STANDARD LED DOME LIGHT ⊕ - 4" ROUND LED DOME LIGHT ⌘ - WALL SWITCH 	<ul style="list-style-type: none"> ▭ - PANEL W/ LIFELINE & CABLE HATCH △ - MOTOR BASE PLUG ≡ - 2 BULB FLUORESCENT ≡ - 1 BULB FLUORESCENT 	<ul style="list-style-type: none"> ● - QUARTZ LIGHT ⌘ - WALL SWITCH ○ - 15 AMP RECEPT ● - 20 AMP RECEPT ● - GFI RECEPT 	<p>APPROVED: _____</p> <p>BREVO TRAILERS</p> <p>19319 COUNTY ROAD 8, BRISTOL IN 46507 PHONE: 574.848.7500 - FAX: 574.848.7550</p>
		<p>N/P - NON POWERED</p> <p>12v = 12 VOLT POWERED</p> <p>110v = 110 VOLT POWERED</p> <p>A/C = AIR CONDITIONER</p> <p>W/F = WIRE & FRAME</p>	<p>× - D RING</p> <p>E - E TRACK</p> <p>▨ - ATP</p> <p>(T/C) - TIRE COMPARTMENT</p> <p>DRAWN BY: ××××</p>